

BLADE 180 CFX HELICOPTER Precision CNC Titanium X Swashplate INSTRUCTION

MICROHELI CO., LTD.

COPYRIGHT © 2017 MICROHELI®

1 PRECISION CNC TITANIUM X SWASHPLATE MH-18FX012



Apply Loctite to all screws

- 3mm Titanium Ball (Short)x2
- 3mm Titanium Ballx2
- Stainless Steel Ball Linkage w/ Pinx1
- 8x12x2.5mm Radial Bearingx1

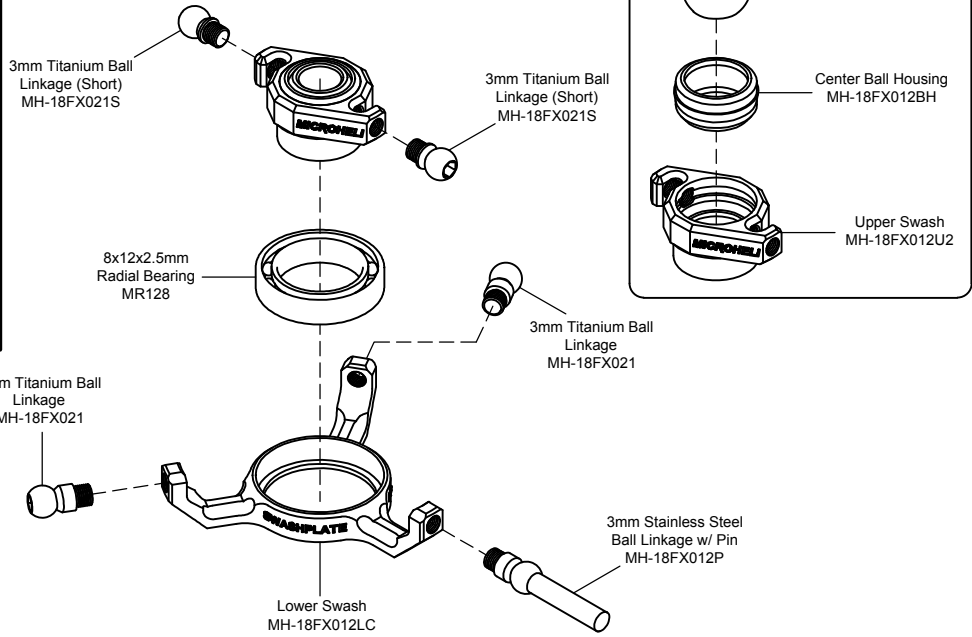

Apply Loctite

CAUTION: Please check your model helicopter carefully before attempt to fly!

REV. 18FX012-011214-01